



**THE  
GLASSHOUSE**

660 12TH AVENUE  
NEW YORK, NY 10019  
+1 212 242 7800  
INFO@THEGLASSHOUSES.COM

# EXPERIENCES TRANSFORMED



# CONTENT

THE VENUE	01	THE VERSATILITY	10
THE LOCATION	03	THE ENERGY	11
THE ARRIVAL	04	THE ALLURE	12
THE SCALE	07	THE LOOKBOOK	14
GREEN ROOMS	08	THE TOUR	18
THE SPECIFICATIONS	09		



# THE VENUE

NEW SPACE, NEW PARADIGM

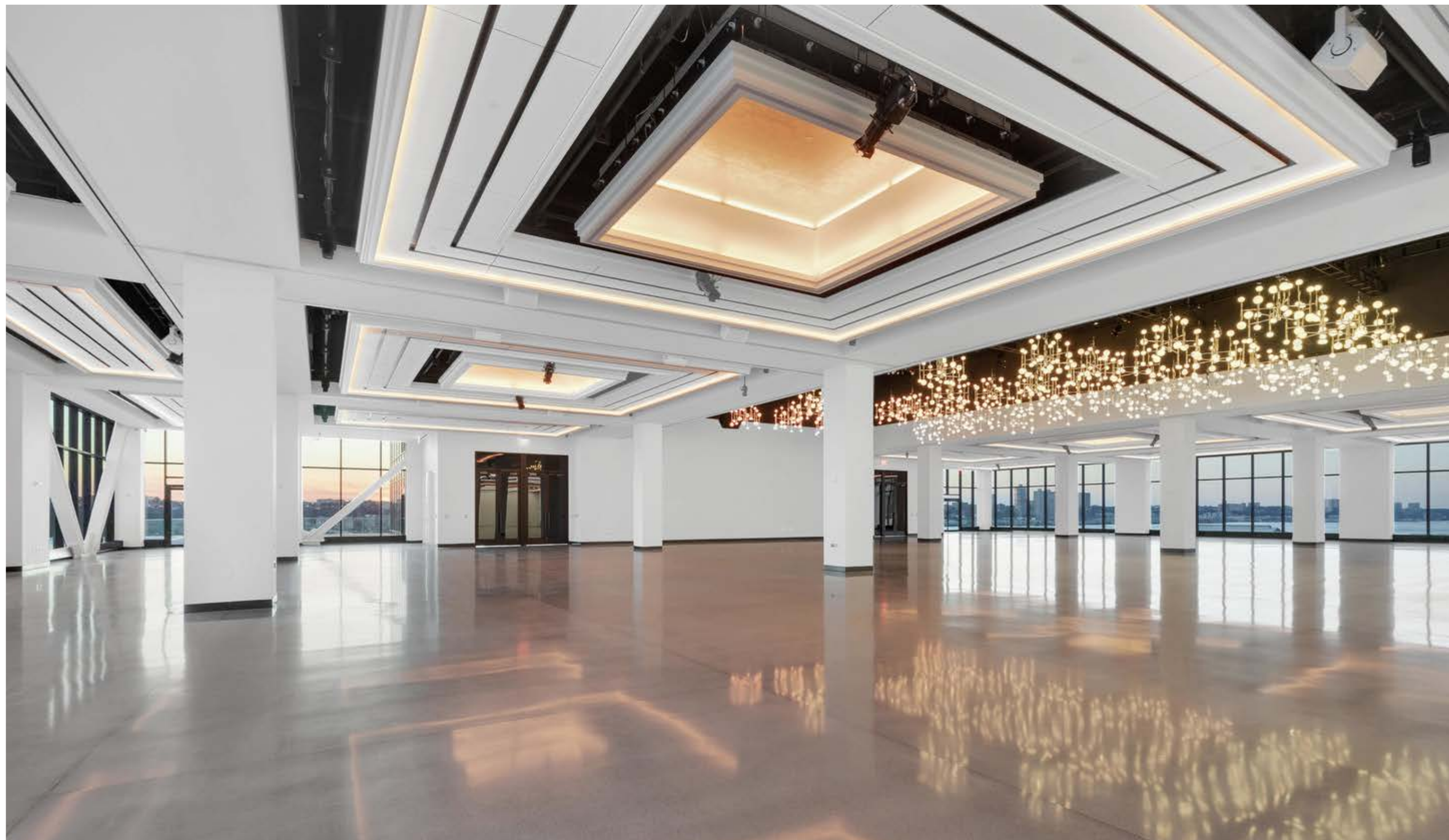

**The Glasshouse** is the preeminent private event space of **NYC**. Newly completed in 2021, the acclaimed venue is operated by a team of experienced and agile professionals that apply **leading service standards** to deliver remarkable experiences.



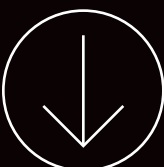

# THE VENUE

NEW SPACE, NEW PARADIGM

## PANORAMIC

- Two outdoor terraces with direct access to event space.
- Private terraces at all Green Rooms.
- Expansive views of Manhattan, Hudson River, and beyond throughout venue.

## TAILORED FOR YOU

- Diverse and comprehensive set of curated preferred vendors.
- On-site inventory of tables, chairs, linens and bar glassware.
- Exclusive production services vendor to execute all audio, video, lighting and rigging scopes.
- Secure and reliable Wi-Fi and hard line custom internet packages.

- Extensive opportunities to incorporate brand activations and immersive experiences.

## AMENITIZED

- State of the art audio, video and lighting capabilities.
- Furnished VIP Lounge.
- Furnished Green Rooms (3) with outdoor terraces.
- Production rooms (3).
- Rooms with private restrooms, walk-in marble showers, smart TVs and advanced AV connectivity (3).
- Separate VIP entrance.
- Ample and efficient coat check.

CHAPTER 01  
THE VENUE







# THE LOCATION

CENTRAL, ACCESSIBLE, CONVENIENT

## ADDRESS

660 12th Avenue (West Side Highway)  
between 48th and 49th Streets  
New York, NY 10019

## NEIGHBORHOOD

**The Glasshouse** is withing walking distance of the primary Central Business District of NYC, and offers easy access to numerous restaurants, hotels, tourist attractions, and transportation. Situated overlooking the Hudson River, the venue provides a scenic view for guests.

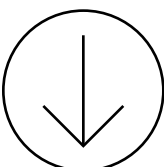





# THE ARRIVAL

ELEVATING THE FIRST IMPRESSION

The **Glasshouse** lobby creates a sophisticated welcome atmosphere for guests with a mix of neutral tones and customizable lighting, sound and branding options available.

**ATTENTIVE STAFF**

**SECURITY AND PRIVACY**

**HEATED CANOPY**

**TRAVERTINE WALLS**

**MARBLE FLOORING**

**MOOD LIGHTING**

**SECURE COAT CHECK**

**SOARING CEILING**

**HIGH SPEED ELEVATORS**

 **THE GLASSHOUSE**

WAITING AREA  
CHECK IN  
WITH SECURITY

A





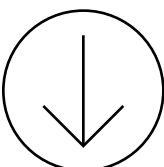

# THE ARRIVAL

ELEVATING THE FIRST IMPRESSION

## THE PREFUNCTION LOBBY

Has the capability for added installations such as video walls and product displays and it is complemented by two 2,000 sq. ft outdoor terraces, perfect for stylish events.

**MARBLE FLOORING**

**WARM DECORATIVE LIGHTING**

**DIRECT TERRACE ACCESS**

**PRODUCTION INFRASTRUCTURE**

**FLOOR-TO-CEILING WINDOWS**

**IMPRESSIVE WESTWARD VIEWS**

**CONTIGUOUS EXPANSION CAPABILITY**

**STAFFED AT KEY POINTS**

**HIGH FINISH RESTROOMS**

CHAPTER 03  
**THE ARRIVAL**







# THE ARRIVAL

CHAPTER 03  
THE ARRIVAL

ELEVATING THE FIRST IMPRESSION

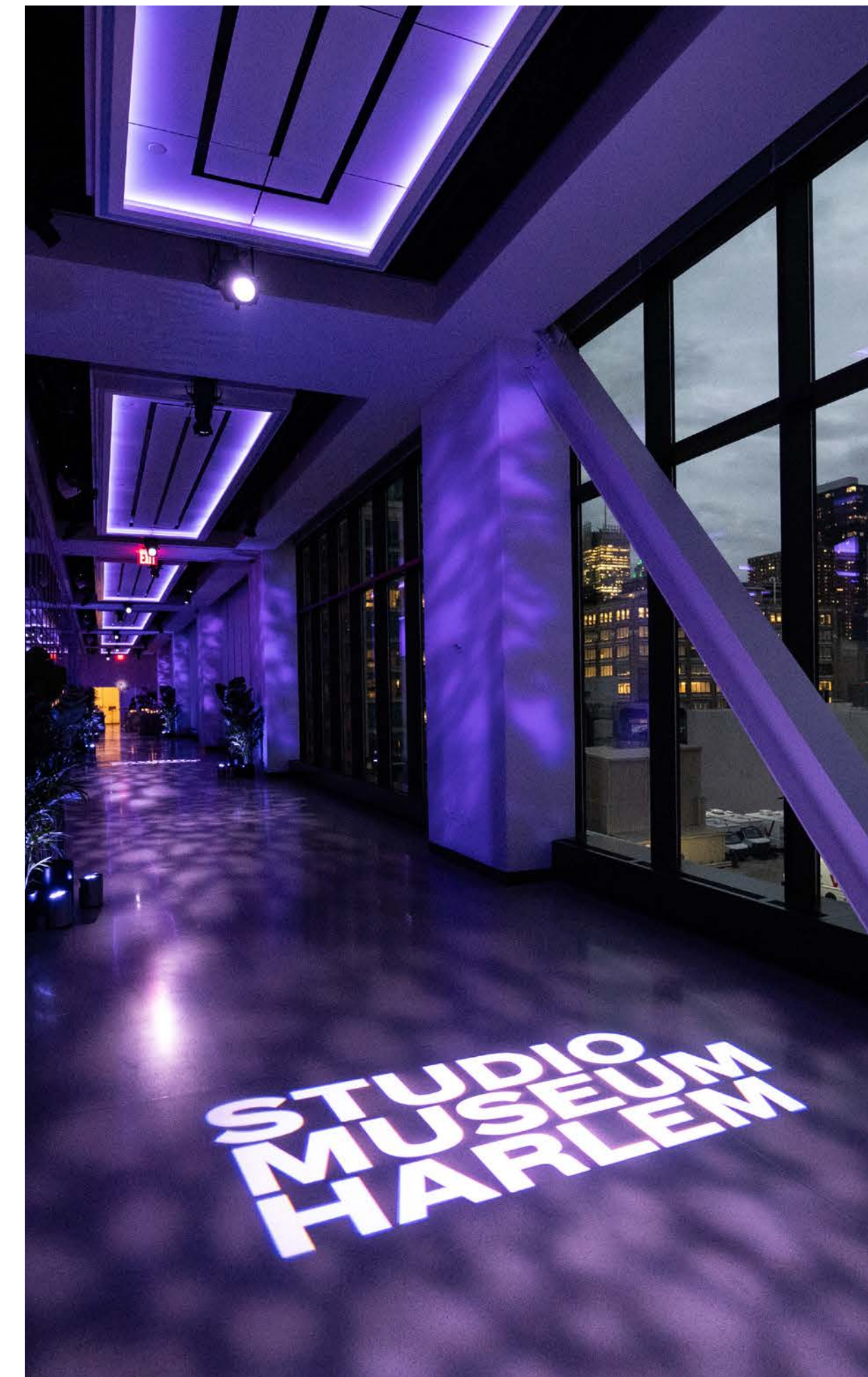
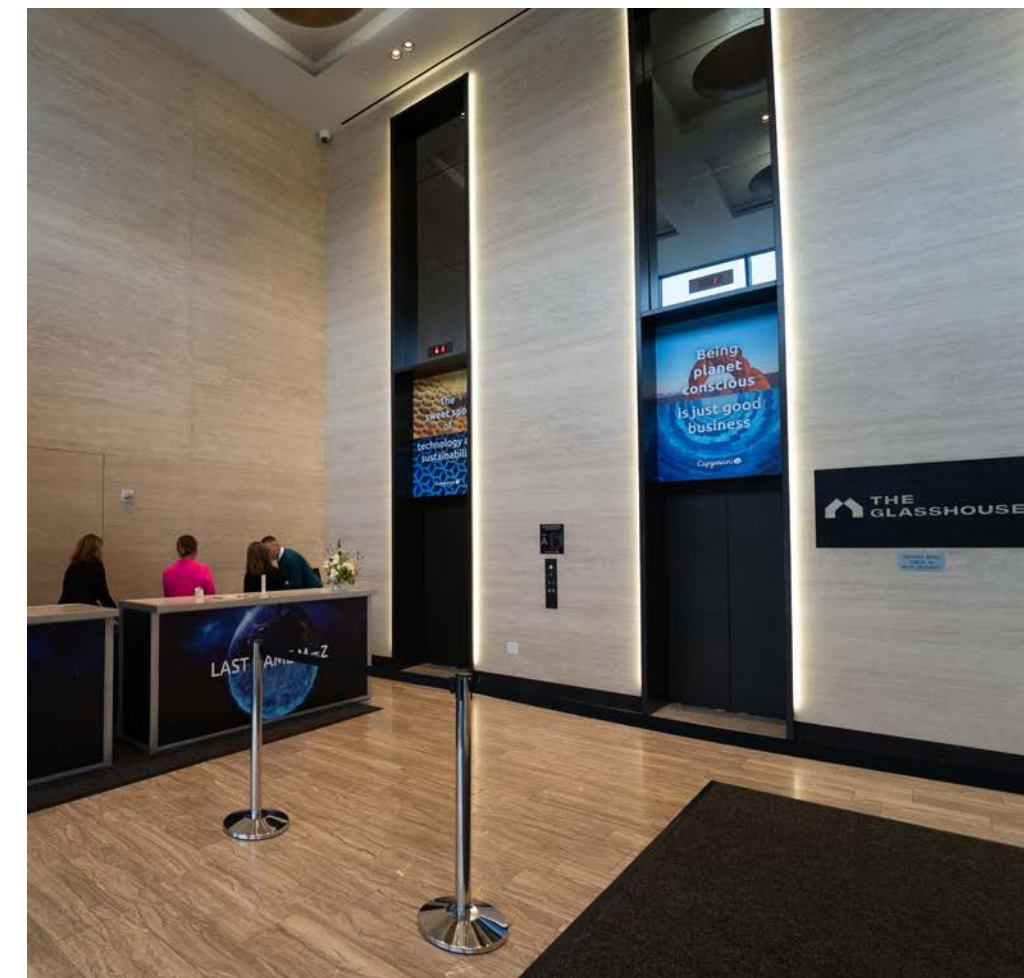
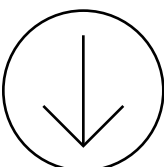





# THE SCALE

ELEVATING THE FIRST IMPRESSION

## FULL EVENT SPACE

30,000 sf. | Capacity: 1,850

Includes: Suite A North, Pop-Up, Suite A South, South Corridor, Suite B and Suite C

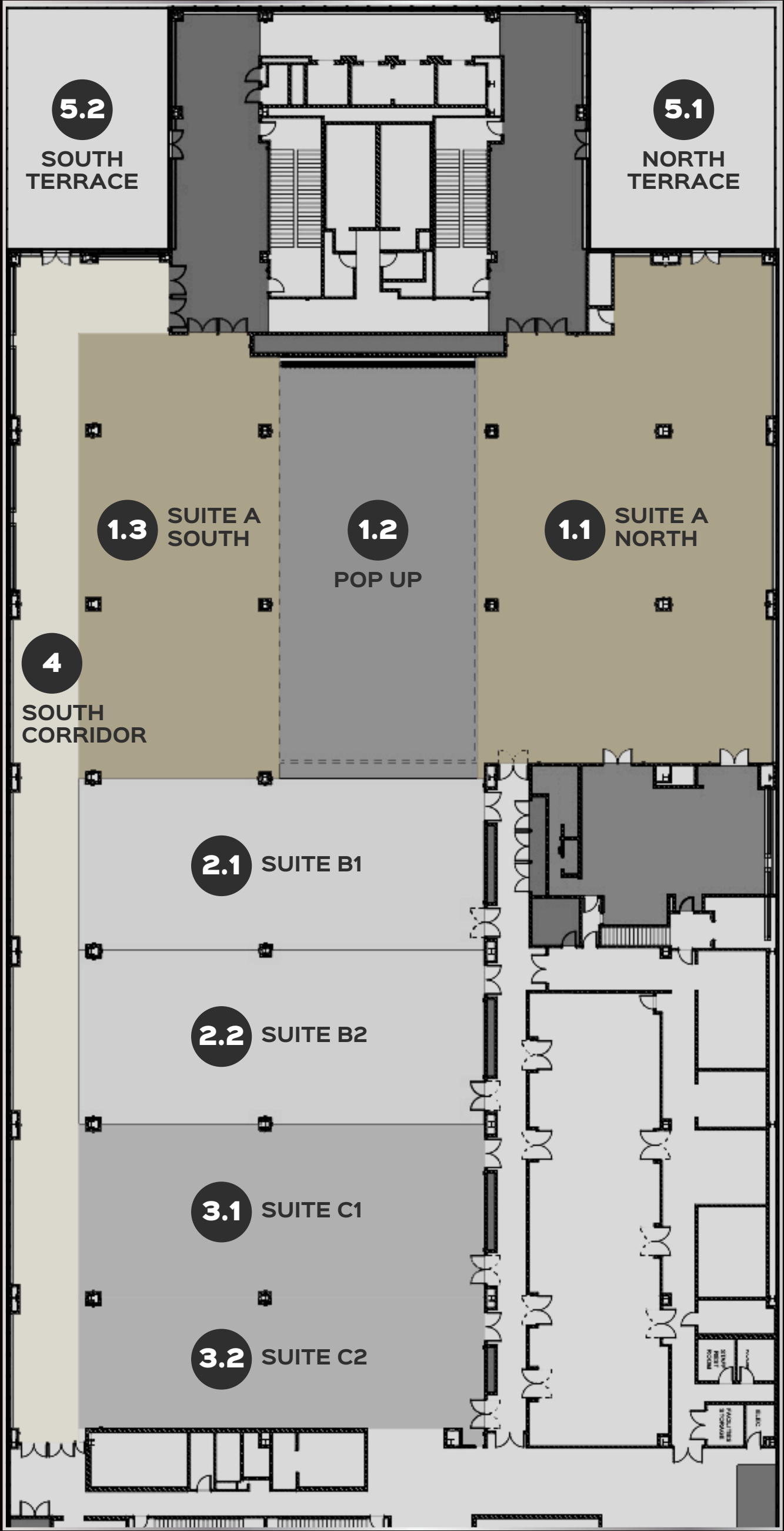

**1 SUITE A**  
14,000 sf.  
Capacity: 900 **(theater)** /  
1,380 **(cocktails)** / 920 **(banquet)**

**1.1 SUITE A NORTH**  
5,900 sf.  
Capacity: 500 **(theater)** / 580  
**(cocktails)** / 375 **(banquet)**

**1.2 POP UP**

**1.3 SUITE A SOUTH**

**4 SOUTH CORRIDOR**

**2 SUITE B**  
5,800 sf.  
Capacity: 800 **(theater)** / 580  
**(cocktails)** / 375 **(banquet)**

**2.1 SUITE B1**  
3,000 sf.  
Capacity: 400 **(theater)** / 290  
**(cocktails)** / 185 **(banquet)**

**2.2 SUITE B2**  
3,000 sf.  
Capacity: 400 **(theater)** / 290  
**(cocktails)** / 185 **(banquet)**

**5 TERRACES**

**5.1 NORTH TERRACE**  
2,000 sf.  
Capacity: 200 **(cocktails)**

**5.2 SOUTH TERRACE**  
1,800 sf.  
Capacity: 170 **(cocktails)**

**3 SUITE C**  
5,100 sf.  
Capacity: 725 **(theater)** / 510  
**(cocktails)** / 325 **(banquet)**

**3.1 SUITE C1**  
3,000 sf.  
Capacity: 400 **(theater)** / 290  
**(cocktails)** / 185 **(banquet)**

**3.2 SUITE C2**  
2,200 sf.  
Capacity: 300 **(theater)** / 200  
**(cocktails)** / 145 **(banquet)**

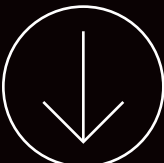





# GREEN ROOMS

CHAPTER 05  
THE SCALE

FLOORPLANS FOR THE 6TH FLOOR

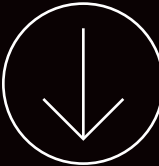
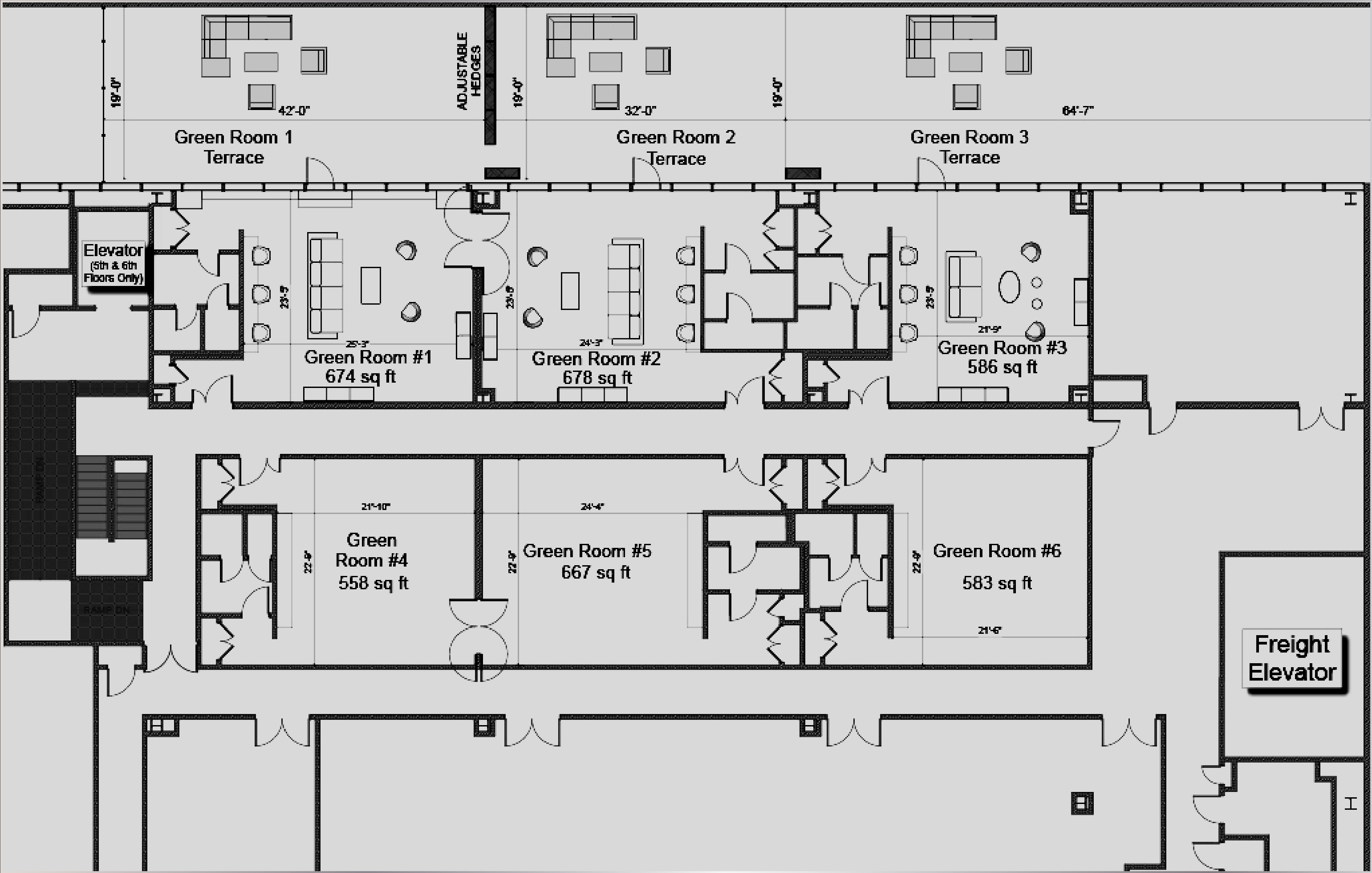



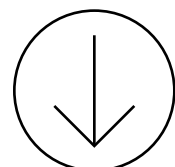

# THE SPECIFICATIONS

LEADING FUNCTIONALITY

**SPACE**

- 1,850 person capacity
- 30,000 sf. event space
- 3,400 sf. front-of-house pre-function space
- 2,700 sf. outdoor space

**AUDIO**

Dante enabled Martin sound system (concert ready) with Yamaha consoles providing comprehensive sound distribution.

**POWER**

300-amp 3 phase available conveniently distributed throughout the space from company switches.

**VERSATILITY**

Flexible room configurations allow for various design styles, diverse event types and guest counts.

**VIDEO**

Video infrastructure provides discreet video control room with installed production switching system, with single mode fiber and Cat-6 signal connectivity distributed throughout the event space and green rooms.

**DOCK & ELEVATORS**

- Loading dock on 49th street.
- Oversized freight elevator.

**CEILINGS**

Lighting Soffits extend to 14' high wit recessed bay ceilings at 17' ang hanging pipe positions at 15'. Theatrical pop-up area extends to 27' high.

**LED DISPLAY**

ROE Ruby 2.3mm LED panels and display monitors, suspended from a grid system to maximize event space.

**AMENITIES**

Dedicated locker rooms for vendors.

**LIGHTING**

Fully integrated house and theatrical lighting system controlled by ETC Gio and Paradigm consoles, including 36 custom dynamic chandeliers in the pop-up area, and motorized blackout and sun window shades.

**RIGGING**

1 ton and 1/2 ton rigging points installed in event areas; with motorized battens, truss hoists and rigging geams within the pop-up area.

**KITCHEN**

Large commercial kitchen with two full service lines.





# THE VERSATILITY

## RETRACTABLE PARTITION SYSTEM

### THE GALLERY

Crystal partitions, a corridor used for guest flow, additional prefunction space and/or activation displays.

Individual partitions can be installed at any point along the track (shown as dashed lines in the diagram on the right).

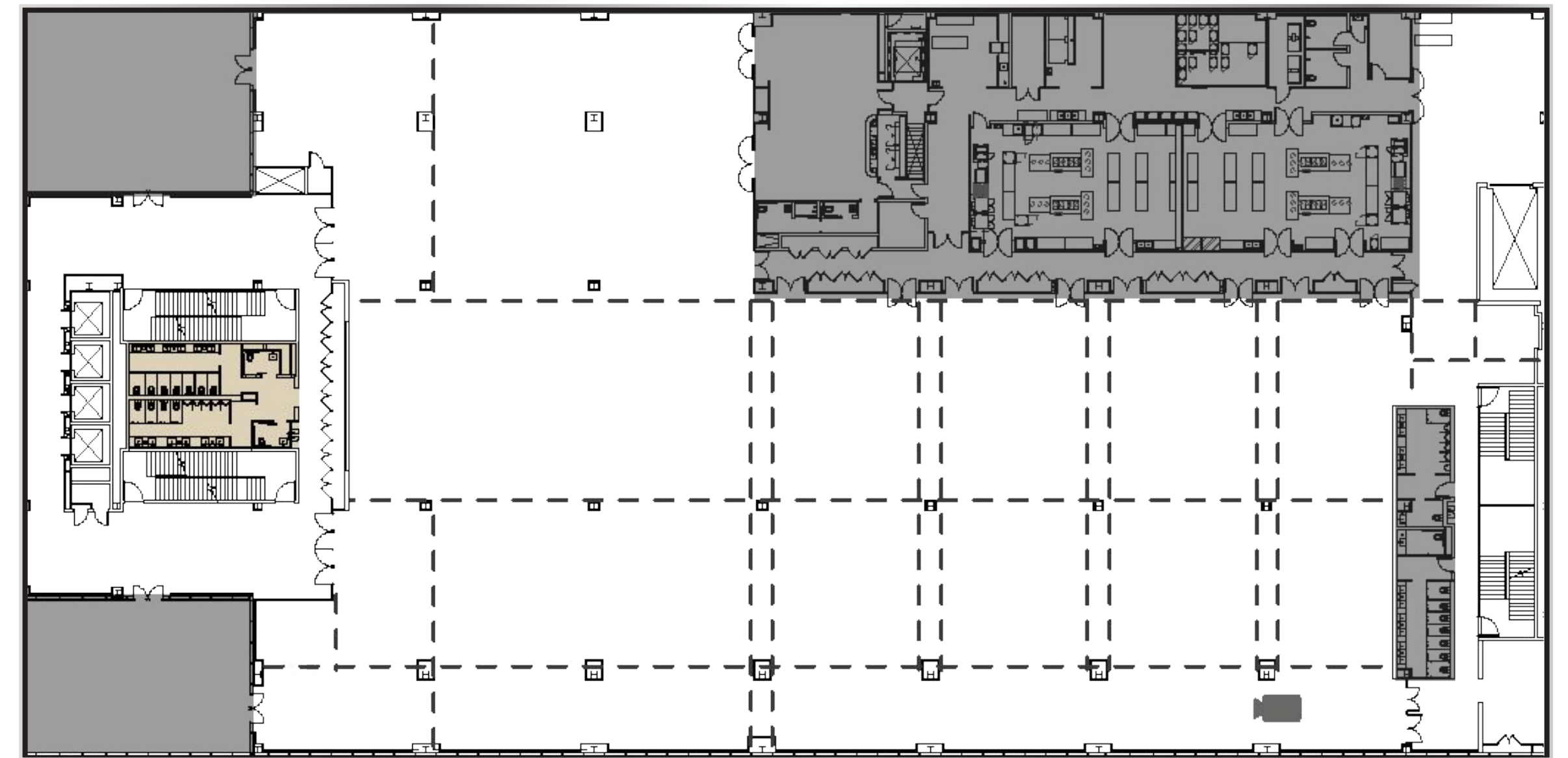

### CRYSTAL PARTITIONS

- Floor-to-ceiling glass
- 56 partitions
- 18 partitions with doors
- STC 44 acoustic rating

### ACOUSTIC PARTITIONS

- Finished with Maharam sound absorbing fabric
- 115 partitions
- 8 partitions with doors
- STC 53 acoustic rating

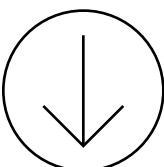





# THE ENERGY

SYNCHRONIZED BRILLIANCE IN MOTION

## DYNAMIC LIGHT FIXTURES

49 color-changing chandeliers surprise guests below as they suddenly descend from 30' above, illuminate and jump into choreography.

Our team can program movement, illumination and color to sync with any performance, video, presentation, DJ set, or soundtrack.

Inmersive, lively and unforgettable, this focal point will surely amplify the mood.

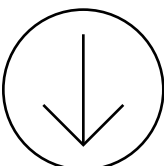
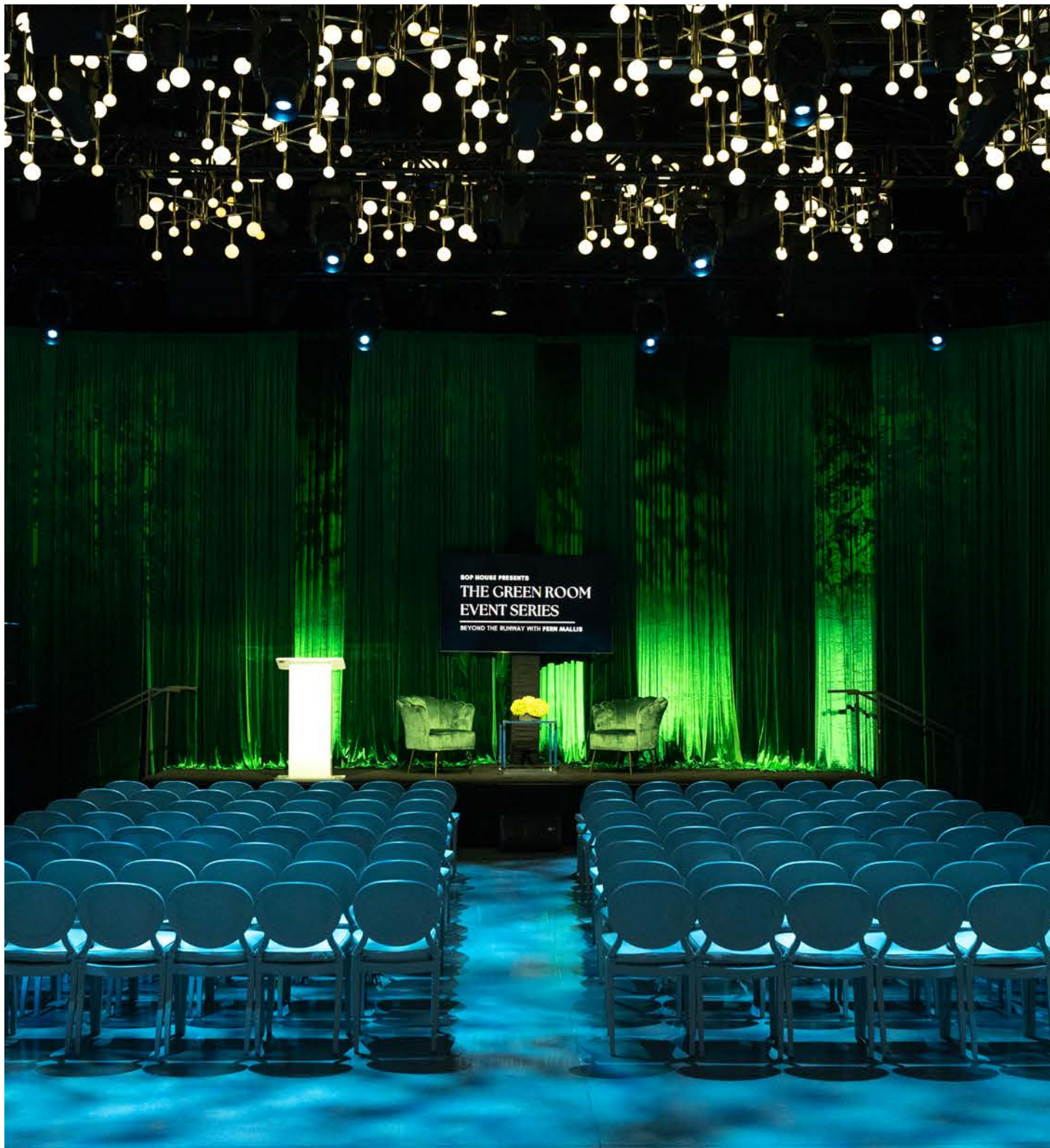





# THE ALLURE

UNMATCHED AMMENITIES



**GREEN ROOM**

w/ fridge, shower, smart TV, AV connections, Sonos, vanity, toiletries and private terrace.



**VIP LOUNGE**

w/ full bar, marble shower suite, smart TV, AV connections, Sonos and custom millwork vanity.



One of seven on site  
**SHOWER SUITES**  
(Green Room 1 pictured).

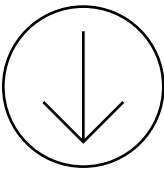





# THE ALLURE

UNMATCHED AMMENITIES



**GREEN ROOM**

w/ shower, smart TV,  
AV connections, Sonos, vanity,  
toiletries and private terrace.



**PRIVATE BAR**

in VIP lounge, finished marble  
and stocked with premium  
beverage options.

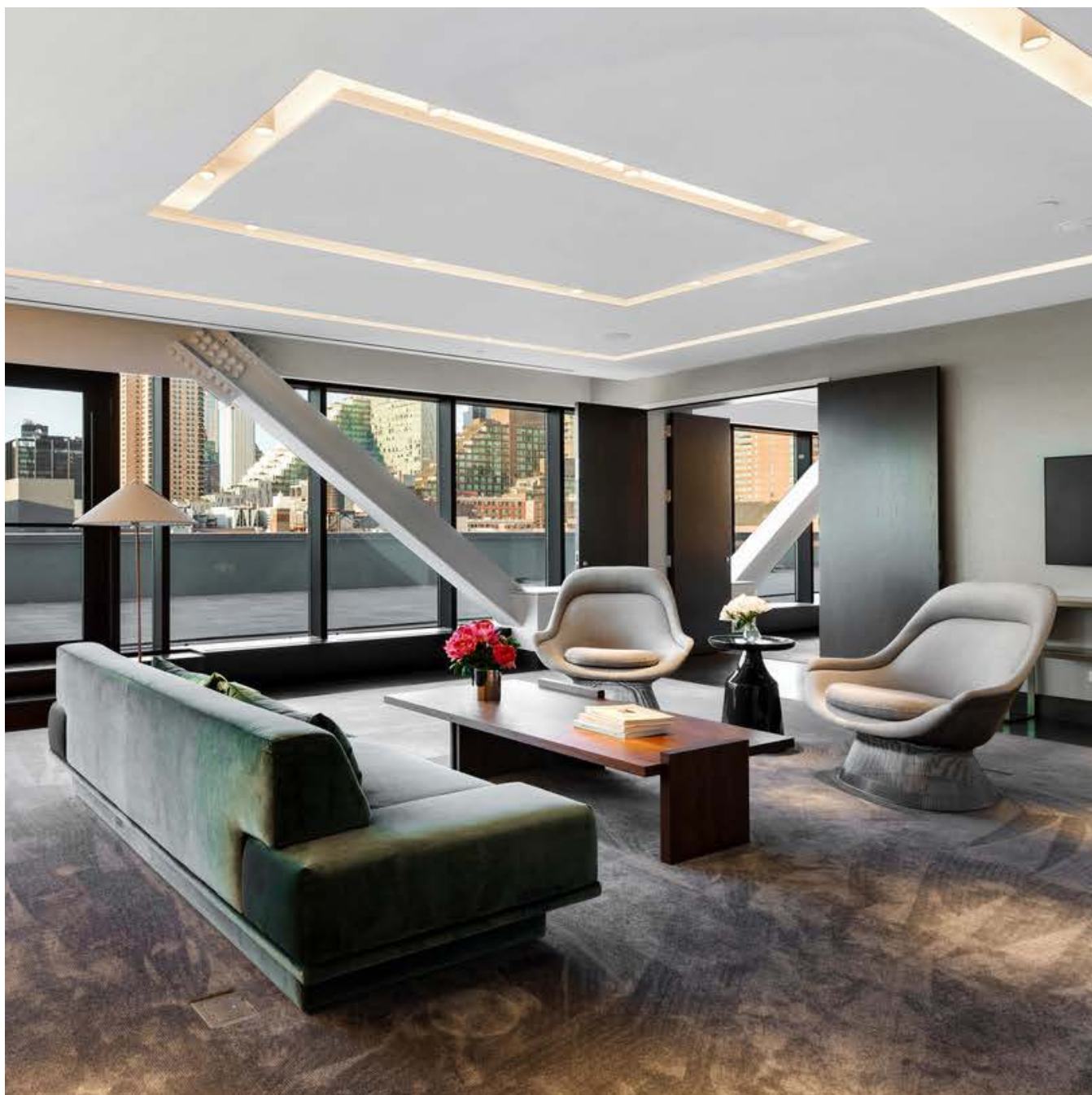

**GREEN ROOM**

w/ shower, smart TV,  
AV connections, Sonos, vanity,  
toiletries and private terrace.

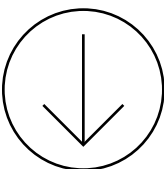



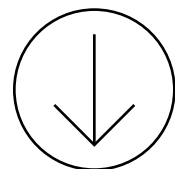

THE LOOKBOOK

# CORPORATE & CONFERENCES

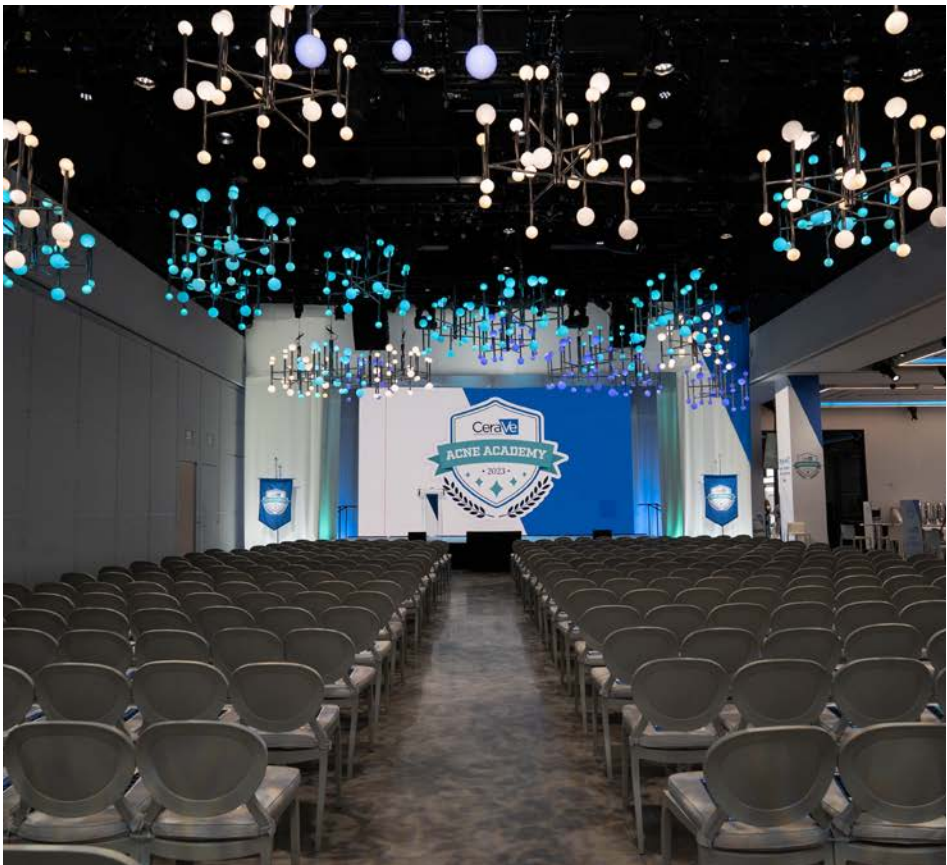





THE LOOKBOOK

# FASHION AND MEDIA EVENTS

CHAPTER 10  
THE LOOKBOOK

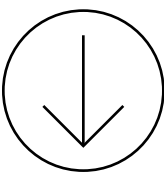
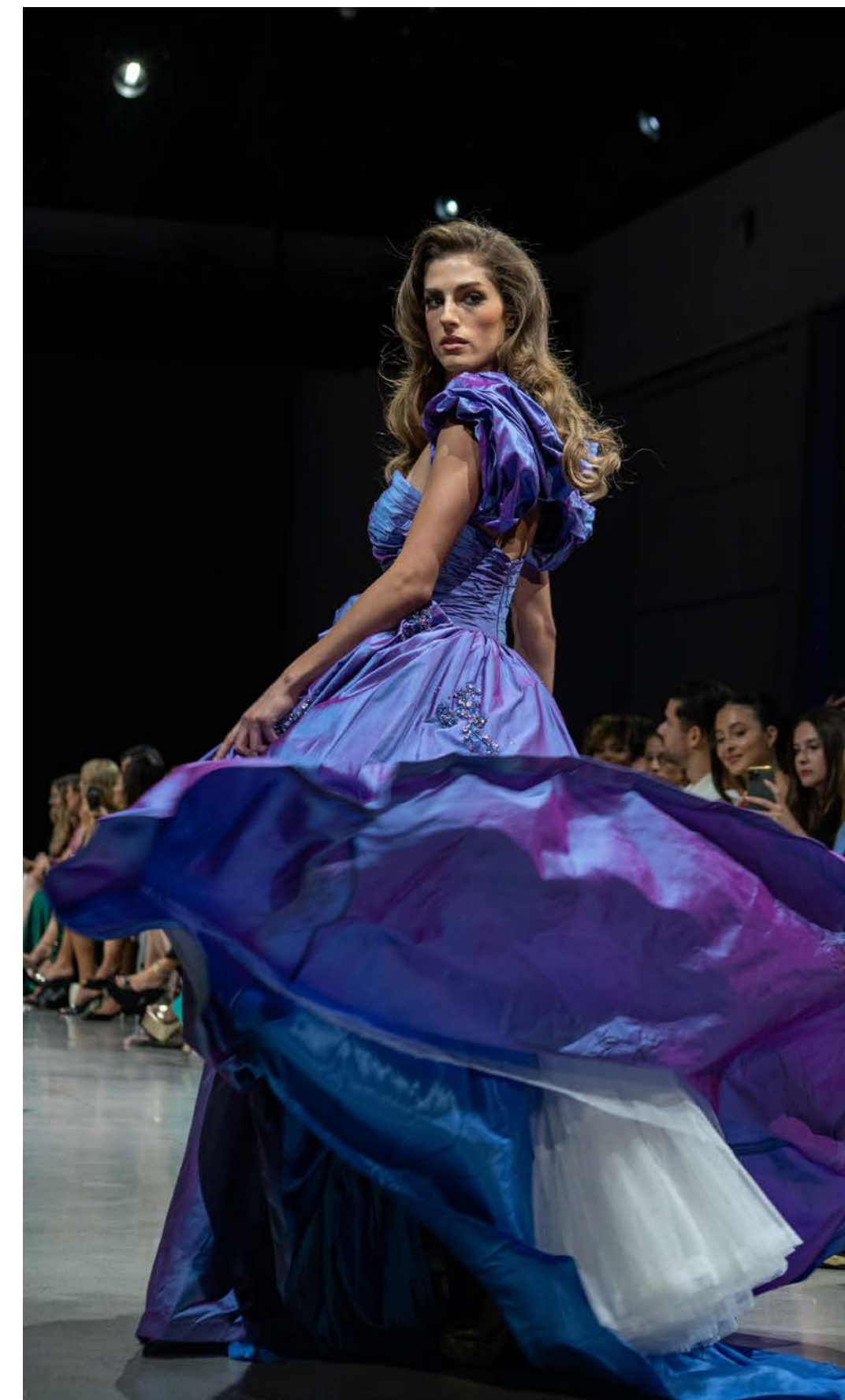
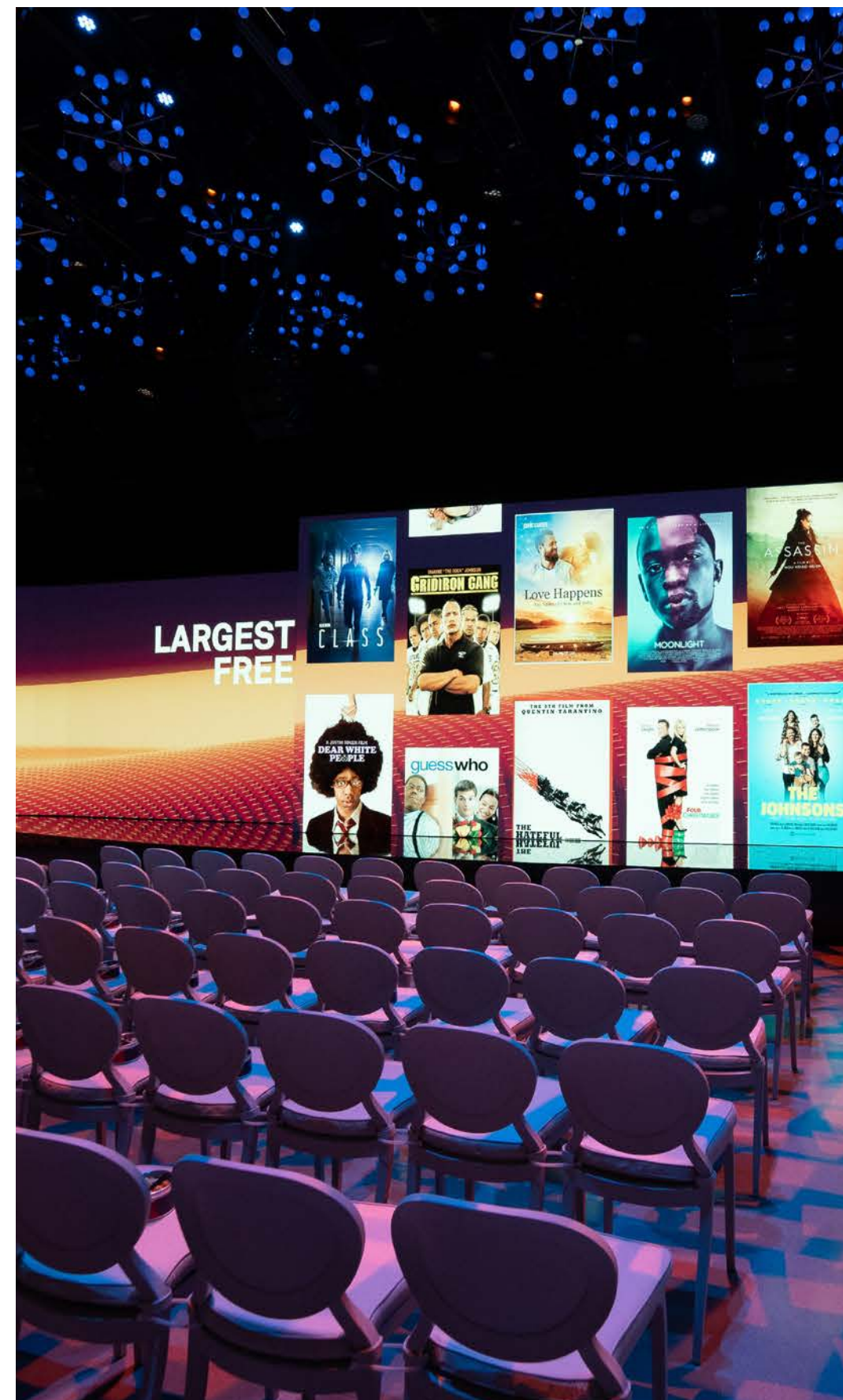





# THE LOOKBOOK

# SOCIAL

# CELEBRATIONS

CHAPTER 10

## THE LOOKBOOK

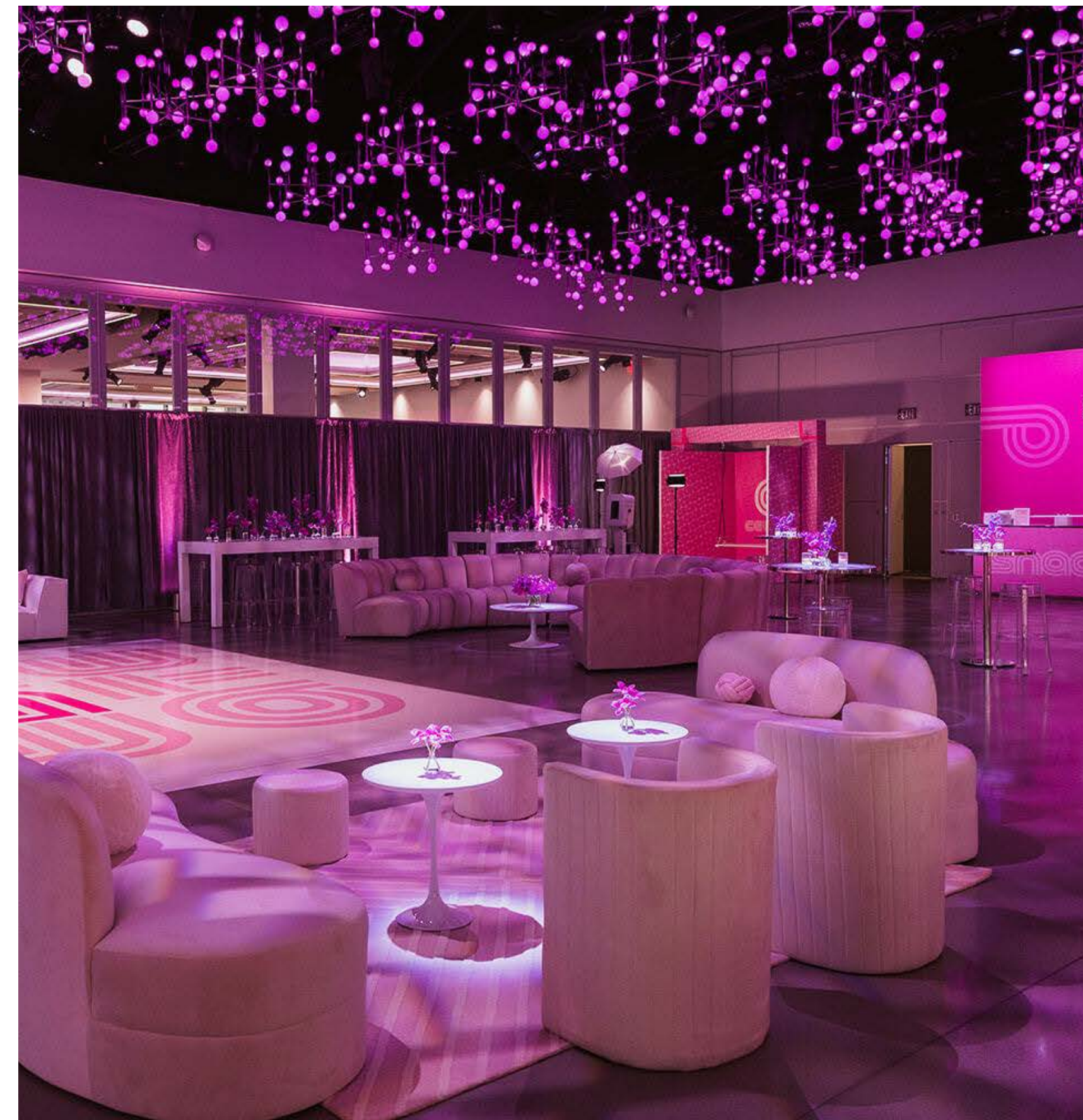
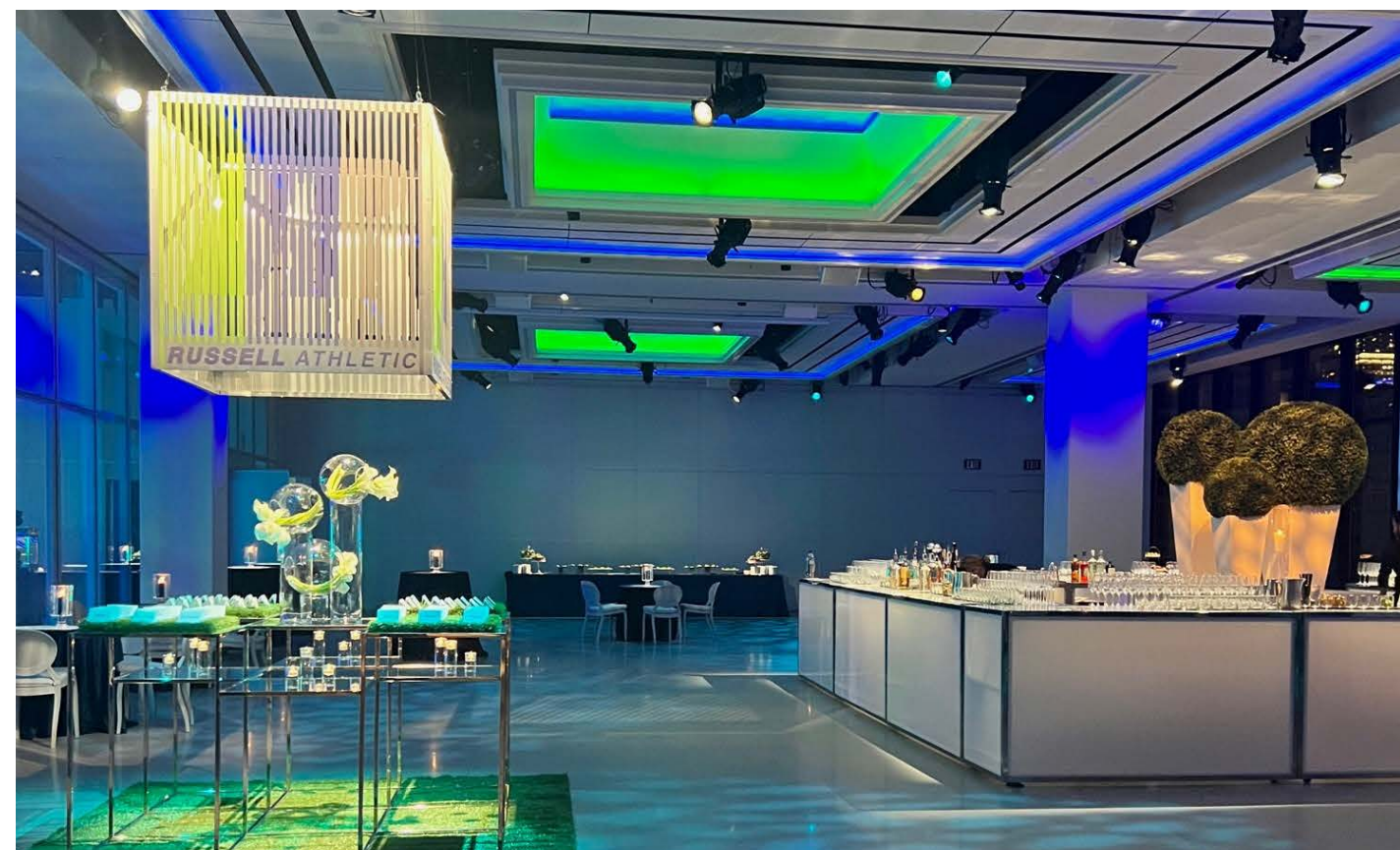
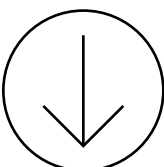





# THE LOOKBOOK

# GALAS & BENEFITS

CHAPTER 10

## THE LOOKBOOK

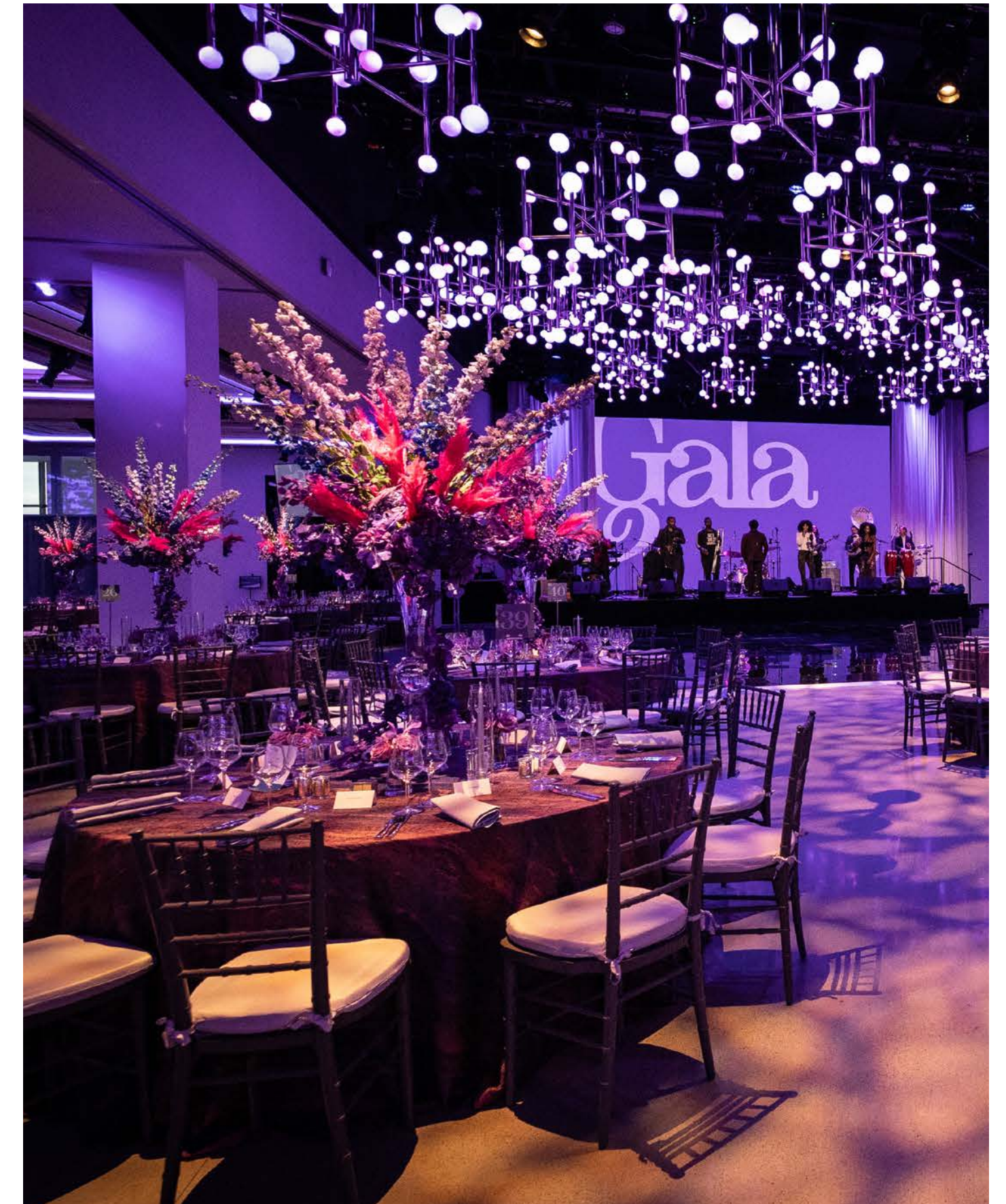
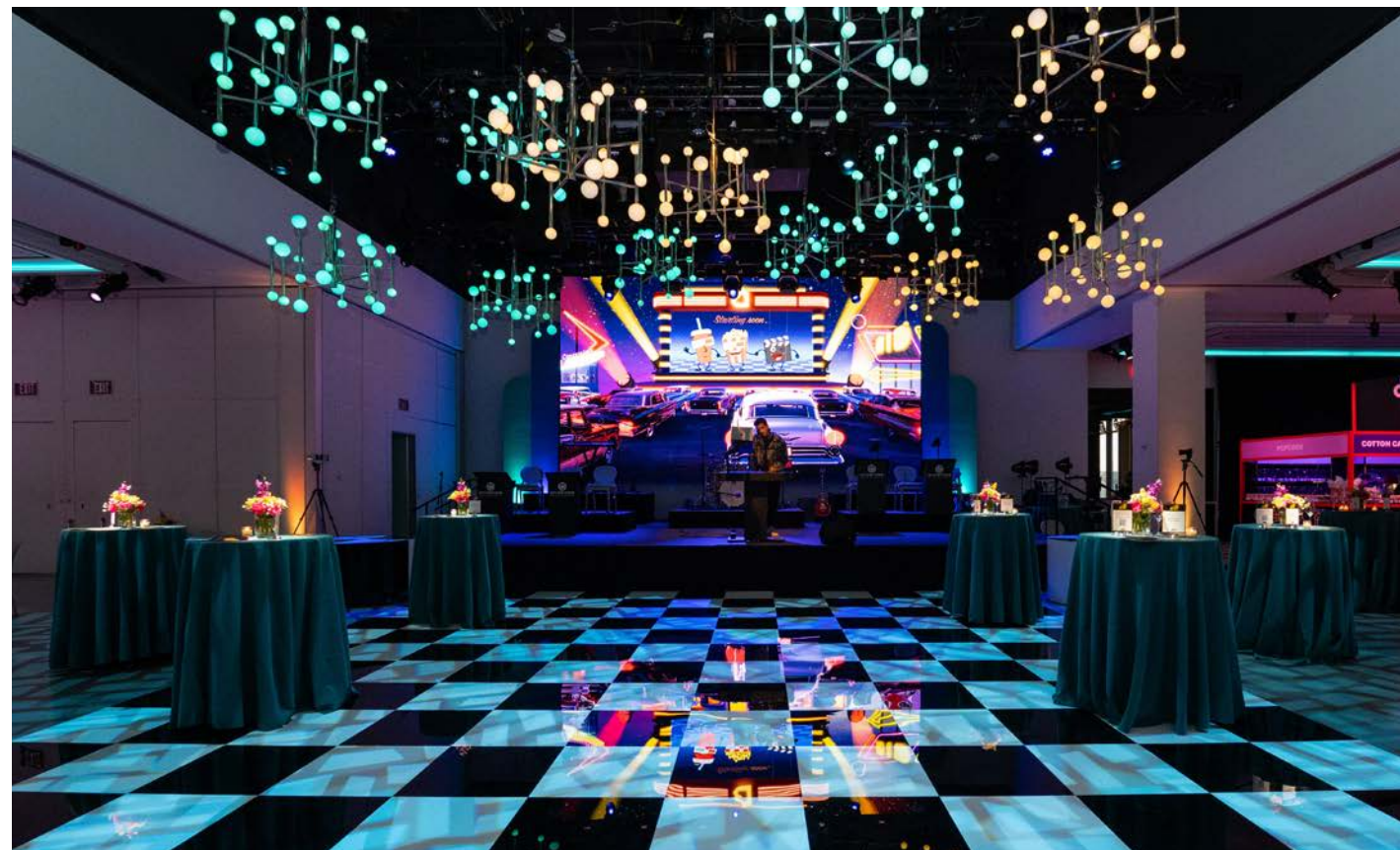
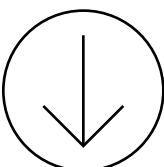





# VIRTUAL TOUR

EXPERIENCE THE GLASSHOUSE

CHAPTER 11  
THE TOUR

THEGLASSHOUSES.COM

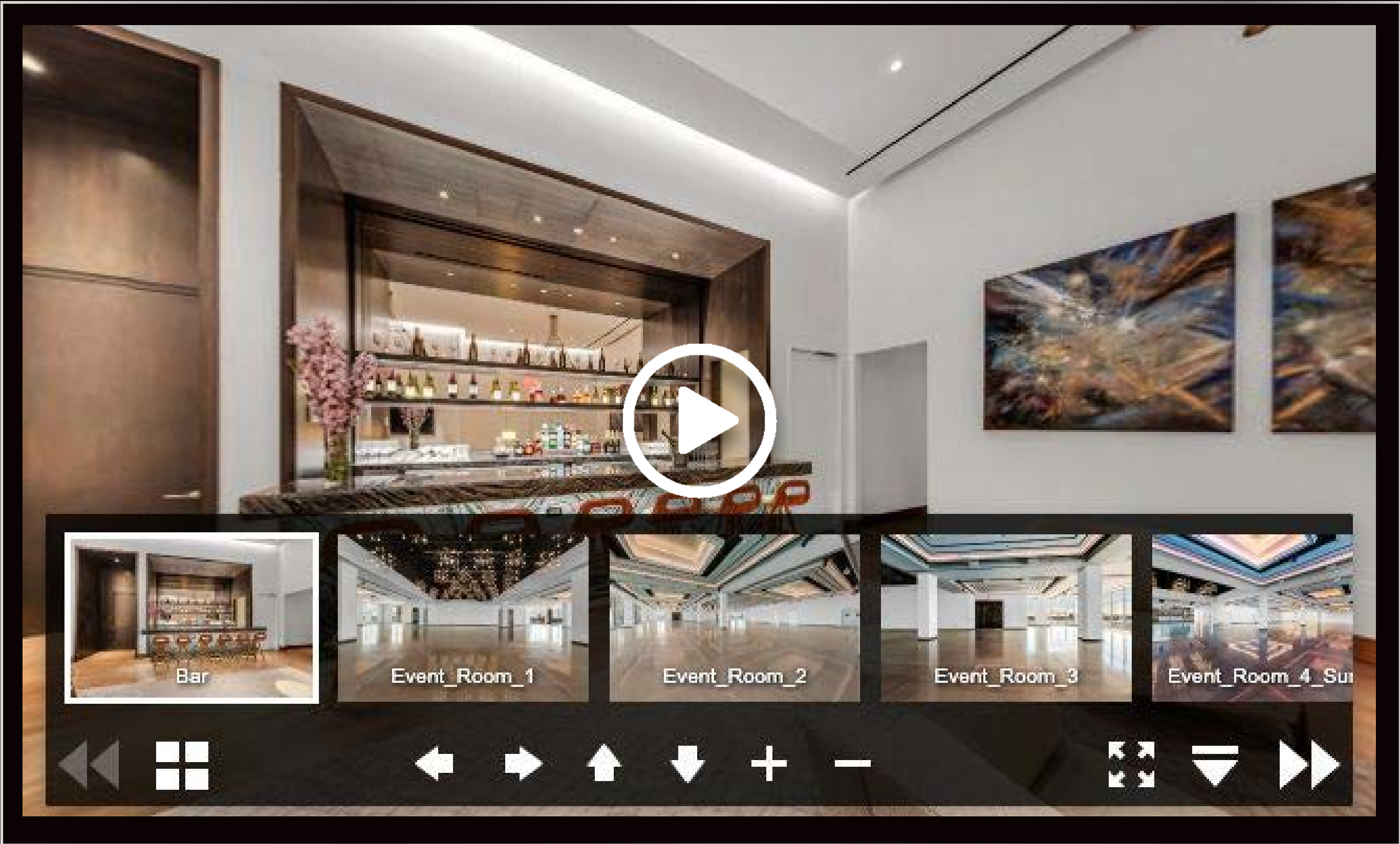
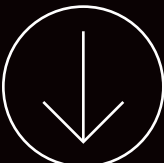

Click the image above to visit the virtual tour





# THE GLASSHOUSE



[www.theqh.com](http://www.theqh.com)

---